

**Compact NSX100-250
FPower NSX / GV7**

9-wire moving connector for breaker
Prise mobile 9 fils pour disjoncteur
Bloque móvil 9 hilos para interruptor

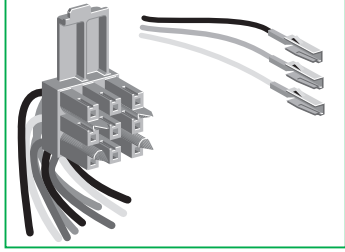

Merlin Gerin
Square D
Télemecanique

Schneider Electric

GHD16271AA-02

Schneider Electric Industries SAS

89, boulevard Franklin Roosevelt
F-92500 Rueil-Malmaison (France)
Tel: + 33 (0)1 41 29 85 00

www.schneider-electric.com



© 2007 Schneider Electric.
All rights reserved.

IMPORTANT NOTE

- This device must be installed by a qualified electrician.
- We cannot accept any responsibility for failure to follow the instructions provided in this document.

REMARQUE IMPORTANTE

- L'installation de cet appareil doit être effectuée par des professionnels de l'électricité.
- Le non-respect des indications de la présente notice ne saurait engager la responsabilité du constructeur.

OBSERVACIÓN IMPORTANTE

- La instalación y mantenimiento de este aparato sólo debe ser realizado por electricistas profesionales.
- El fabricante no se hace responsable en caso de no cumplir con las indicaciones expuestas en este aviso.

重要注意事項

- 本装置必须由合格的电工进行安装。
- 我们不承担任何因未遵循本文档中的指南而导致的责任。

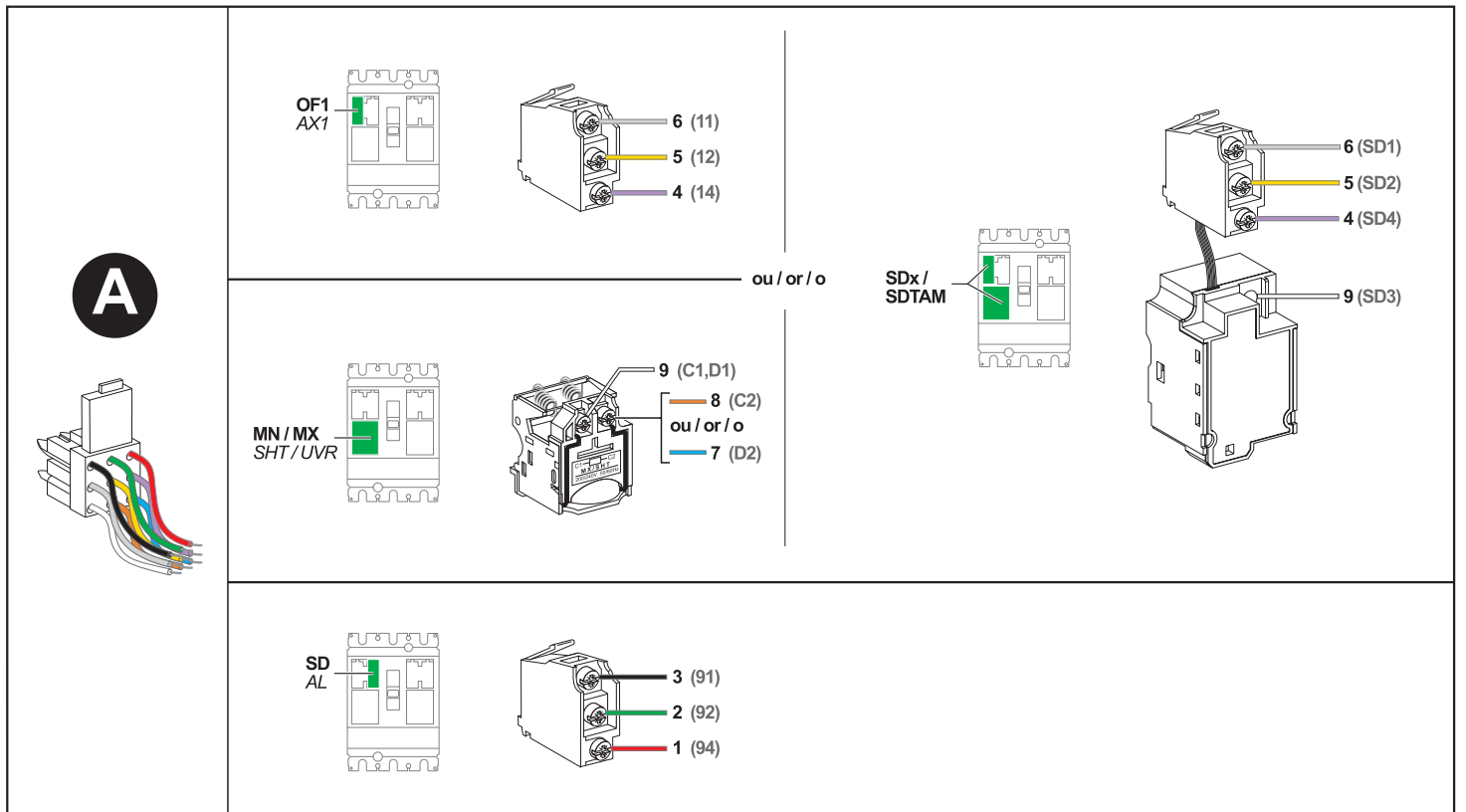
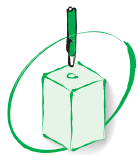
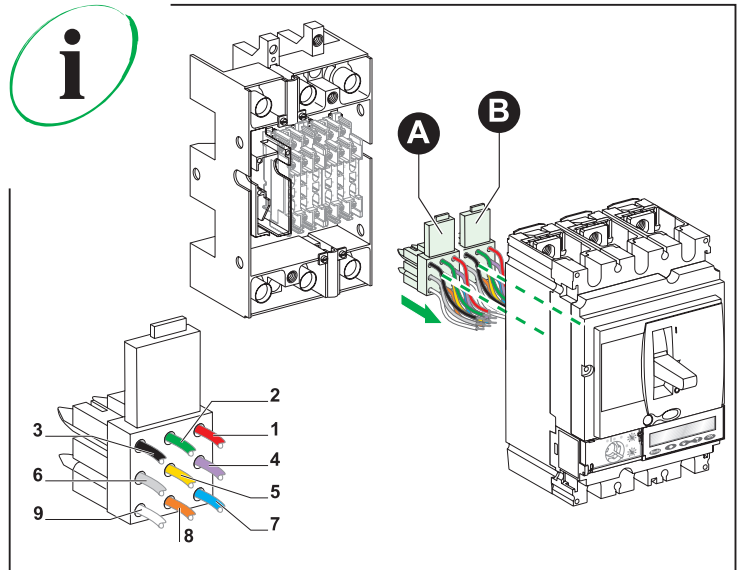
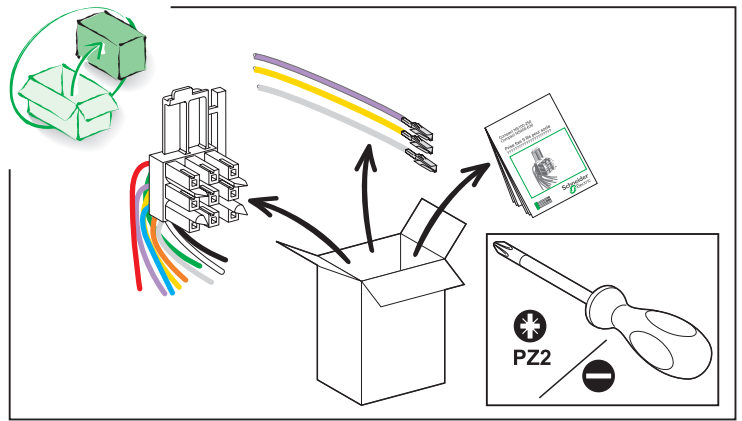

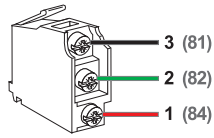
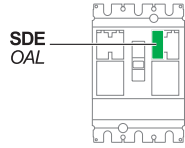
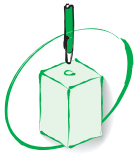

OF2
AX2

SDV
vigi overcurrent
trip switch

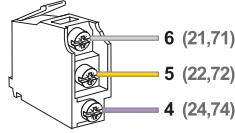
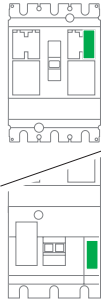

MT
(motor mechanism)

SDE
OAL

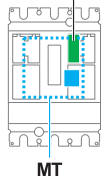

MT

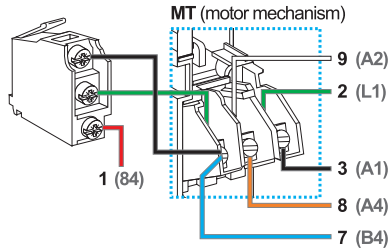

B

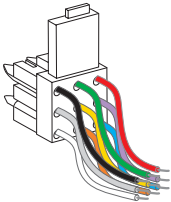

MTc
(Télécommande
communicante)

MTc
+
NSX cord
+
BSCM

NSX cord

BSCM

MTc

NSX cord

BSCM

8 (A1)
2 (B4)

MTc

NSX cord

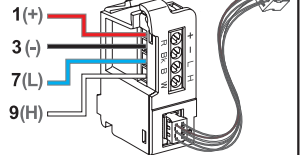
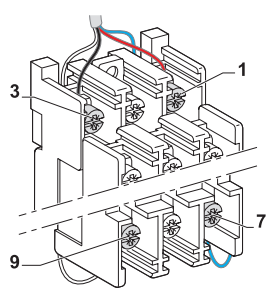
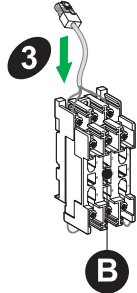
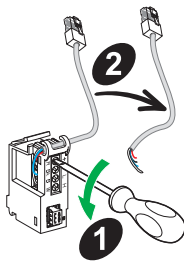
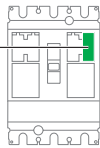

24 V DC
terminal bloc
for trip-unit
power supply

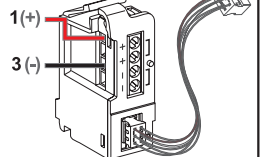
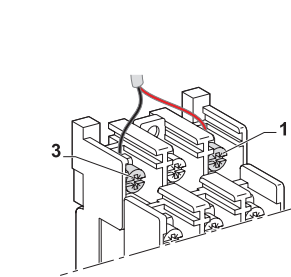
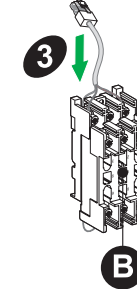
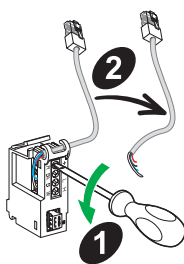

Micrologic
5.2/6.2

ZSI out

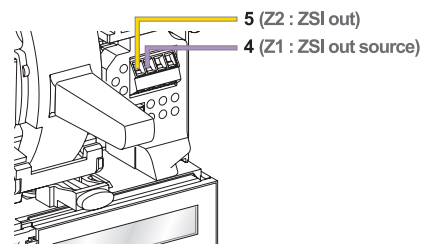
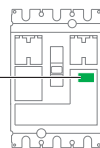

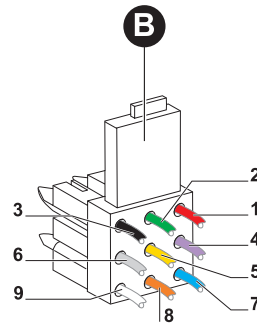
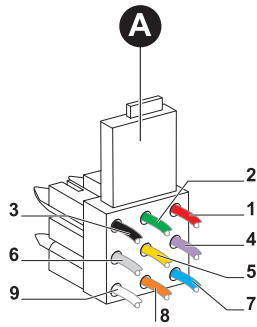

100/250 A

3	2	1
SD	SD	SD
6	5	4
OF1 ^{or/ou} SDx ^{or/ou} SDTAM	OF1 ^{or/ou} SDx ^{or/ou} SDTAM	OF1 ^{or/ou} SDx ^{or/ou} SDTAM
9	8	7
MN ^{or/ou} MX ^{or/ou} SDx ^{or/ou} SDTAM	MX	MN

3	2	1
SDE ^{or/ou} MT ^{or/ou} 24 V (-) ^{or/ou} NSX cord (-)	SDE ^{or/ou} MT ^{or/ou} MTc	SDE ^{or/ou} 24 V (+) ^{or/ou} NSX cord (+)
6	5	4
OF2 ^{or/ou} SDV	OF2 ^{or/ou} SDV ^{or/ou} ZSI out	OF2 ^{or/ou} SDV ^{or/ou} ZSI out source
9	8	7
MT ^{or/ou} NSX cord (H)	MT ^{or/ou} MTc	MT ^{or/ou} NSX cord (L)

- OF1 / OF2 : ON/OFF indication contact** / Contact de position "ouvert/fermé" de l'appareil / *Contacto auxiliar OF "abierto/cerrado"*
- SD : Trip indication contact** / Contact de signalisation déclenchement / *Contacto de señalización de defecto*
- SDE : Fault trip indication contact** / Contact de signalisation défaut électrique / *Contacto de señalización de defecto eléctrico*
- SDV : Earth leakage indication contact** / Contact de signalisation déclenchement différentiel / *Contacto de señalización de defecto diferencial*
- SDTAM : Thermal fault early-break contact** / Module signal défaut thermique avancé à la manœuvre / *Módulo de señalización de defecto térmico avanzado a la maniobra*
- SDX : Output early-break contact** / Module de signalisation à distance / *Módulo de señalización a distancia*
- MN : Undervoltage release** / Déclencheur à minimum de tension / *Bobina de mínima tensión*
- MX : Shunt trip** / Déclencheur à émission de courant / *Bobina a emisión de corriente*
- 24 V : Micrologic power supply** / Alimentation Micrologic / *Alimentación Micrologic*
- ZSI out : Zone Selective Interlocking** / Sélectivité logique ZSI / *Selectividad lógica*
- MT : remote control** / Télécommande / *Mando eléctrico*
- MTc : COM remote control** / Télécommande communicante / *Mando eléctrico comunicante*
- NSX cord : Communication NSX cord terminal block** / Bornier NSX cord de communication / *Bornero cable de comunicación NSX*